

CW-628-A

Cold 、 Hot Water Dispenser

Operation Manual
(Digital Operation Panel for Temperature)

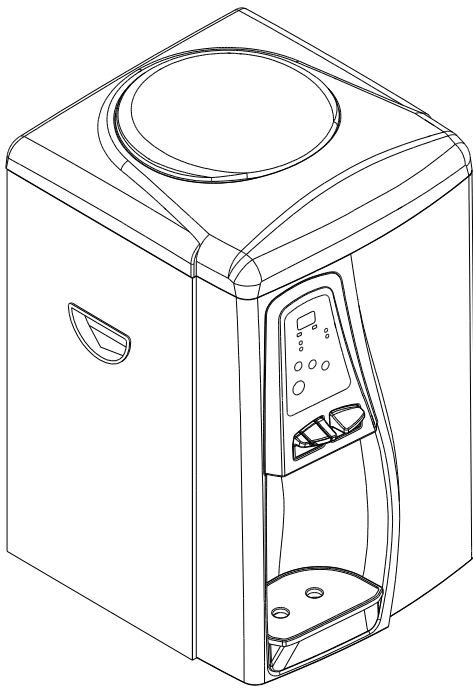

Contents	Page
Preface / Parts	1
Piping Installation	2
Operation Method	3
Safety Reminder	4
Cleaning & Maintenance	5

Please read these instructions completely before operating this unit

Preface / Parts

Before using this machine , we advise you to read this manual thoroughly .
Please follow the instructions to ensure proper operation and the lasting of the machine .

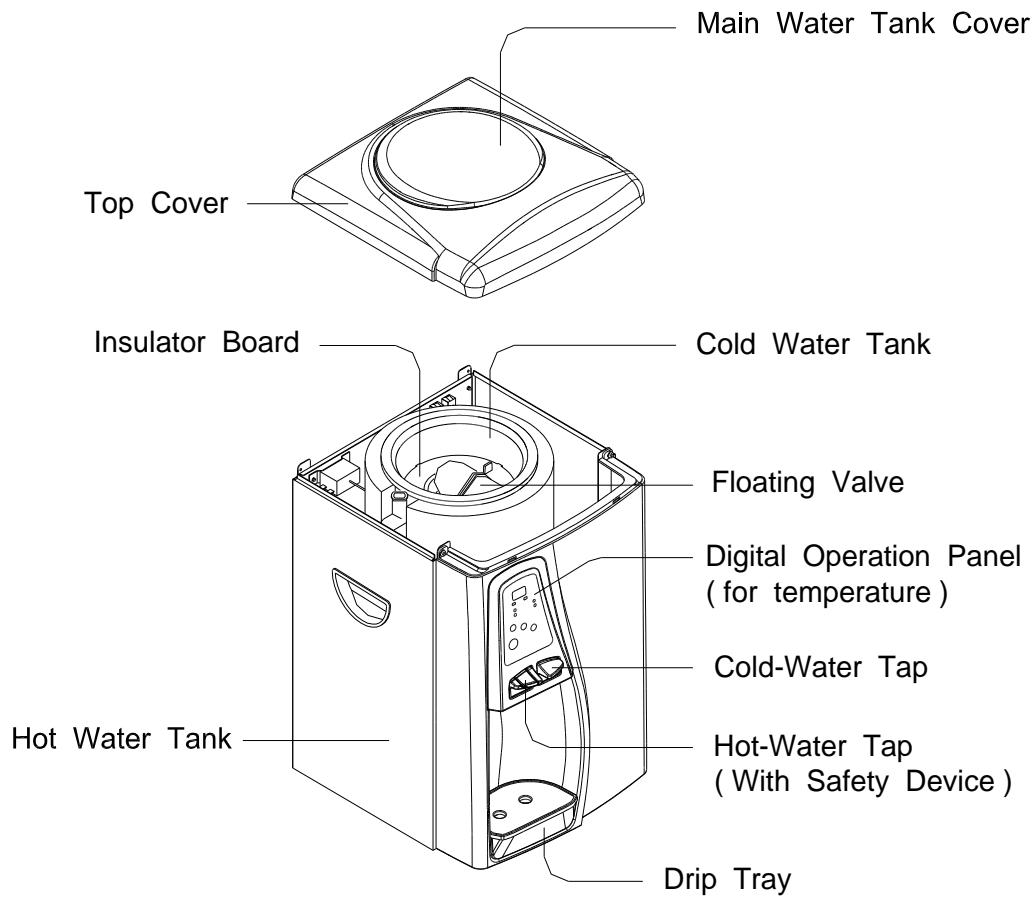

Piping Installation

1. Dismantle original water tap, add tri-way socket and inlet ball valve . see drawing (A)

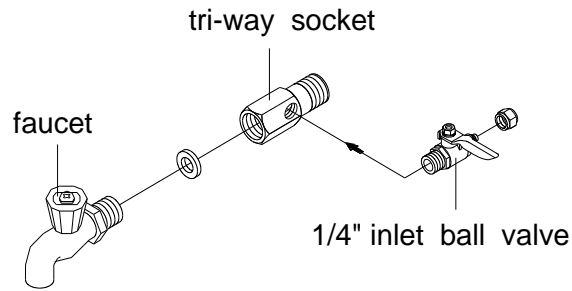

drawing (A)

2. Connect 1/4" PE water pipe between inlet ball valve and inlet connector , see drawing (B)

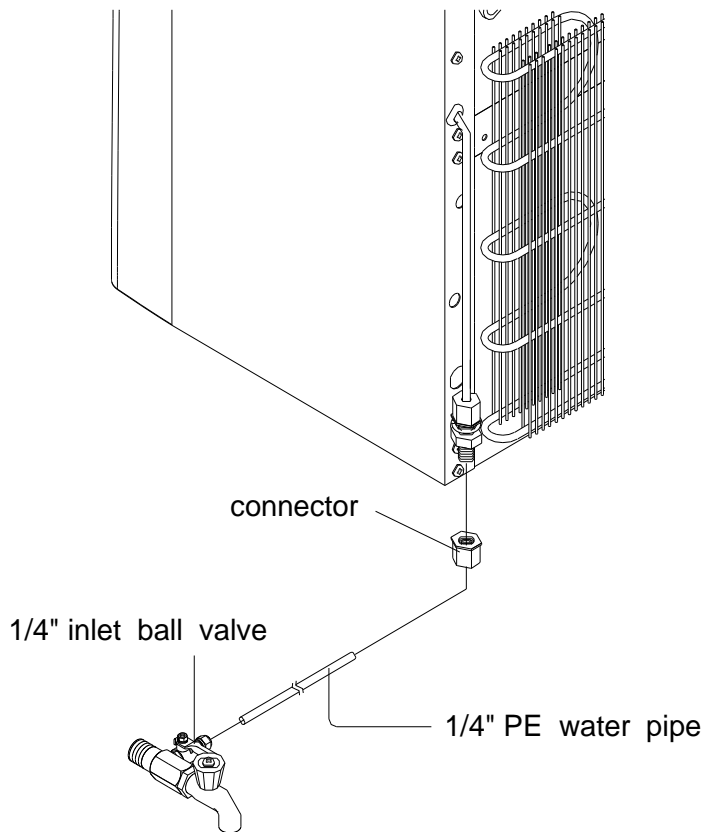

drawing (B)

Operation Method

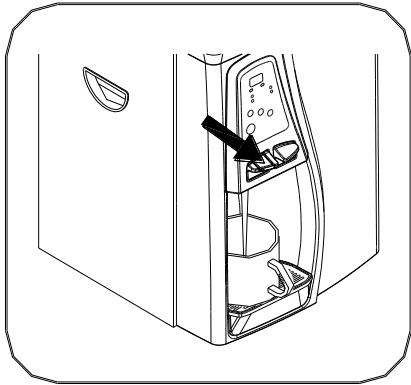

1. After piping system is done, be sure the Hot and Cold Power Switch are off before water-in .

After water full of tank , drain out the 1stround of water (1st round water is not good for drink) . Wait for 2nd round of water , press cold water tap and hot water tap to drain a little bit of water out (it is to make sure water full of tank) . Then, it is ready to turn on Cold Power Switch . 1 minute later, turn on Hot Power Switch .

The machine is ready for server .

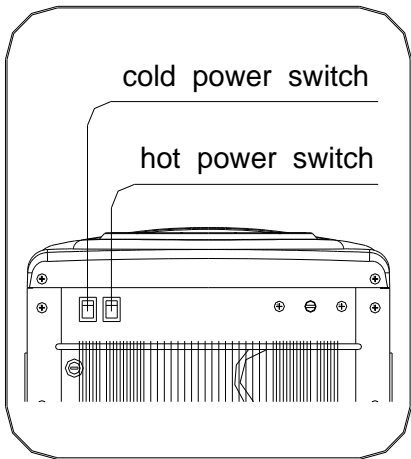

2. Now, Hot lens will go on and digital display show the temperature of hot water . Please push " Set " button for section of hot or cold .

When you need to adjust the hot temperature, please push " Set " button and select hot temperature . Hold on the Set button for 3 seconds until digital flash . Now you could adjust the temperature (from 80~100°C) . After set up is done, push " Set " button again .

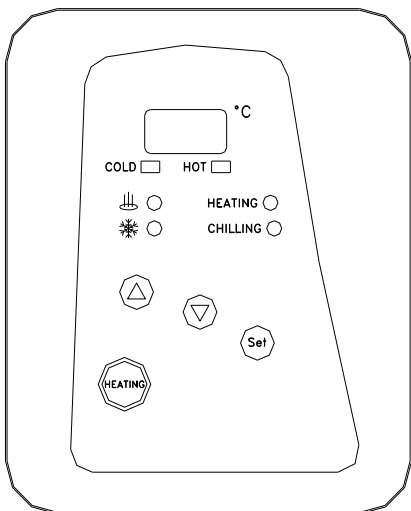

3. When you need to adjust the cold temperature, please push " Set " button and select cold temperature . Hold on the Set button for 3 seconds until digital flash . Now you could adjust the temperature (from 0~5°C) . After set up is done, push " Set " button again .

4. Push " Heating " button , the hot water could reach to 100°C .

Safety Reminder

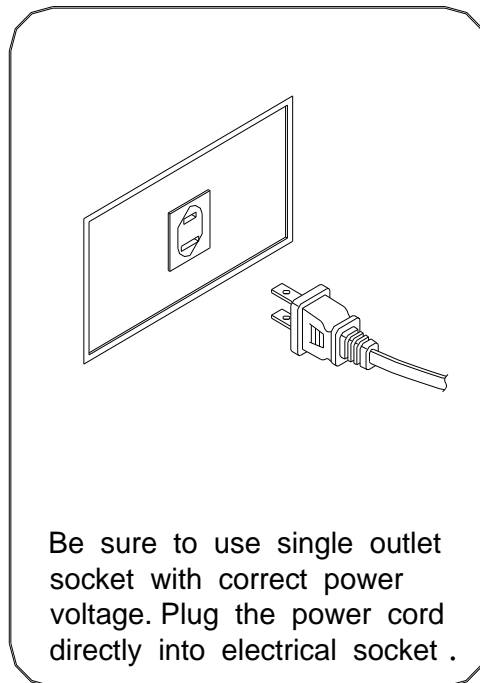
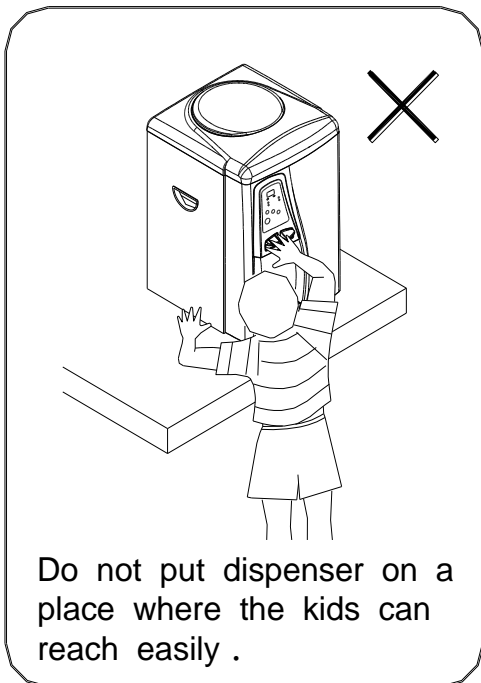
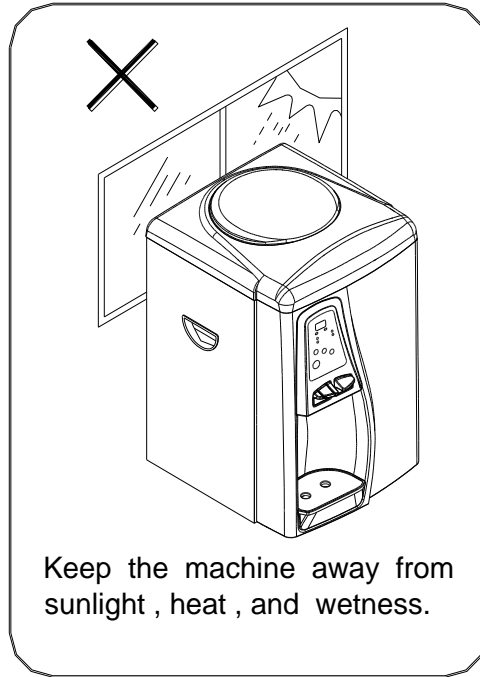
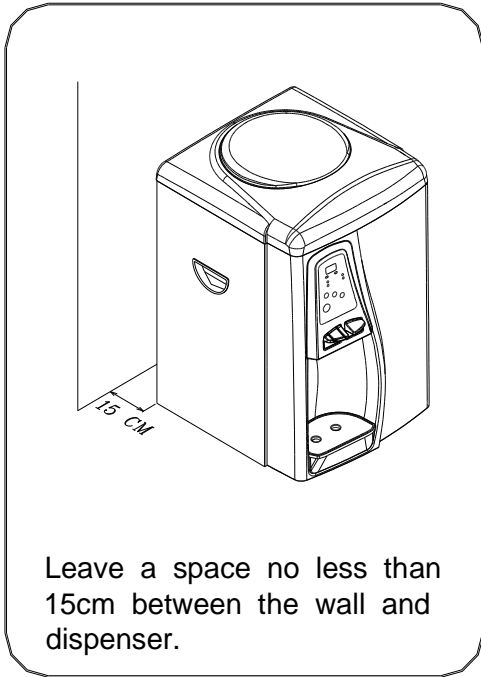

Cleaning & Maintenance

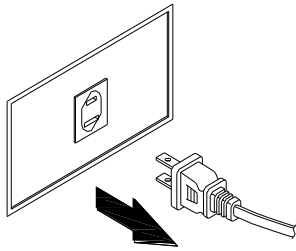

1. Please make sure the plug has been pulled out from outlet before cleaning the water dispenser .

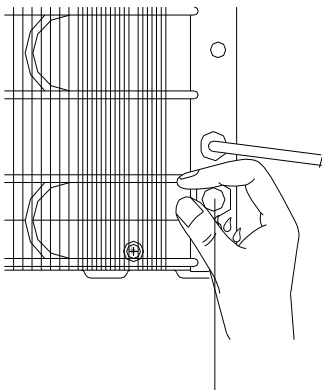

water stop bolt

3. Pull out water stop bolt, which can completely drain out water in cold-water and hot-water tanks .

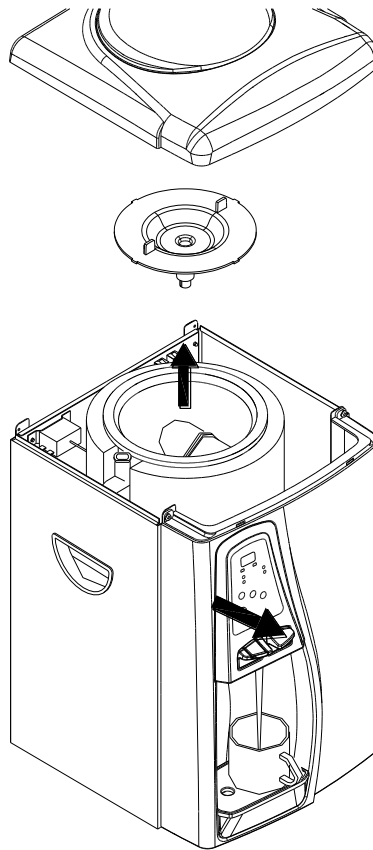

2. Use screwdriver to remove the screws on the top cover , bottom cover, left and right plate . After removing top cover, get off the insulator board, press cold -water and hot-water taps, completely drain out all water . It is ready for clean .

Caution : Please do not let water seep to interior of the unit to avoid damage .